

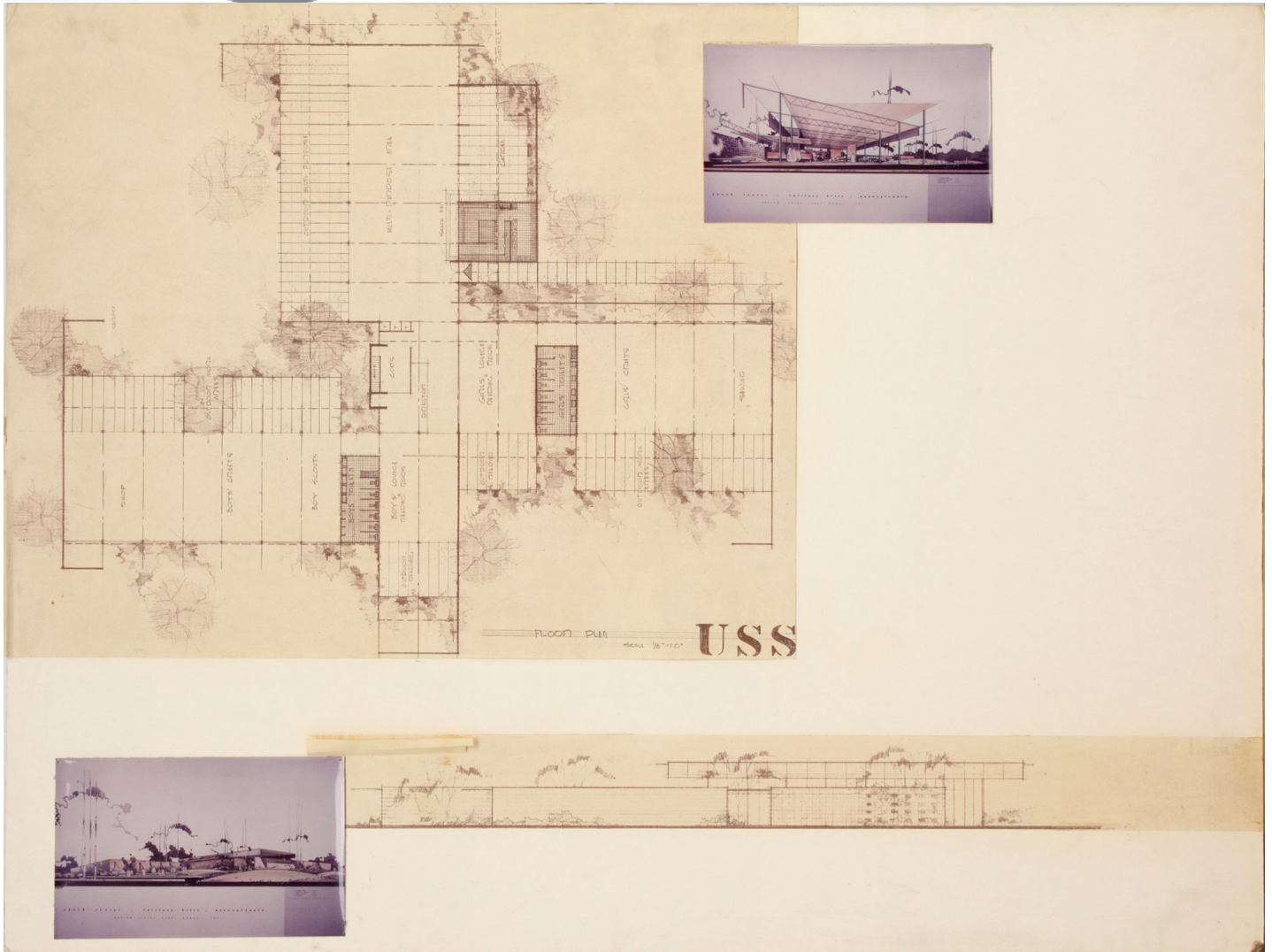

EDWARD CELLA ART & ARCHITECTURE



F.E. Emmons & A. Q. Jones, *Presentation panel for Youth Center, Fairless Hills, PA, with vintage original photographs and reproductions of floor plan, c. 1950*

Vintage silver gelatin prints and reproductions mounted on board, 30 x 40 in. (76.2 x 101.6 cm)
AQUINJ010